

Craftsman Style Playhouse

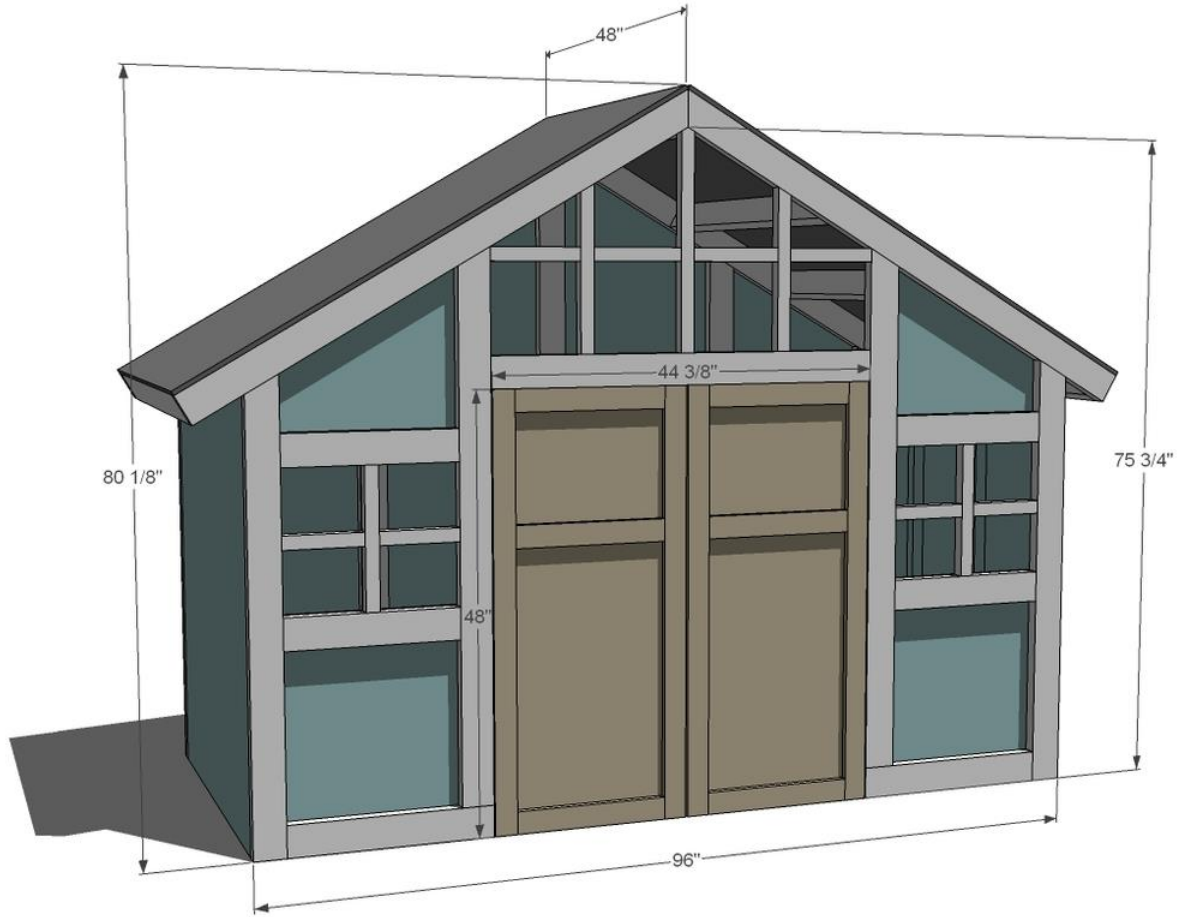

Dimensions



Dimensions shown above

Preparation

SHOPPING LIST

5 - sheets exterior plywood (we used 3/8" but see notes on roofing plywood below)

8 - 2x2 @ 8 feet long

20 - 2x4 @ 8 feet long

1x3s for doors if desired

2-1/2" pocket hole screws (blue coated exterior ones)

Galvanized nails or screws for attaching plywood

Roofing of choice

CUT LIST

Listed in steps

GENERAL INSTRUCTIONS

Take all necessary precautions to build safely and smartly. Work on a clean level surface, free of imperfections or debris. Always use straight boards. Check for square after each step. Always predrill holes before attaching with screws. Use glue with finish nails for a stronger hold. Wipe excess glue off bare wood for stained projects, as dried glue will not take stain. Be safe, have fun, and ask for help if you need it. Good luck!

The entire front wall was built on the ground with a Kreg Jig set for 1-1/2" stock and using 2-1/2" pocket hole screws.

The 2x4 boards are joined together flat (so the wall is 1-1/2" thick before plywood).

Wait until after you build the other walls to use scrap plywood for filling in the blue pieces.

We used 3/8" exterior plywood, just nailed on from back.

Top rafters overhang the outer 2x4s by 6", measured along bottom edge of rafters.

STEP 2

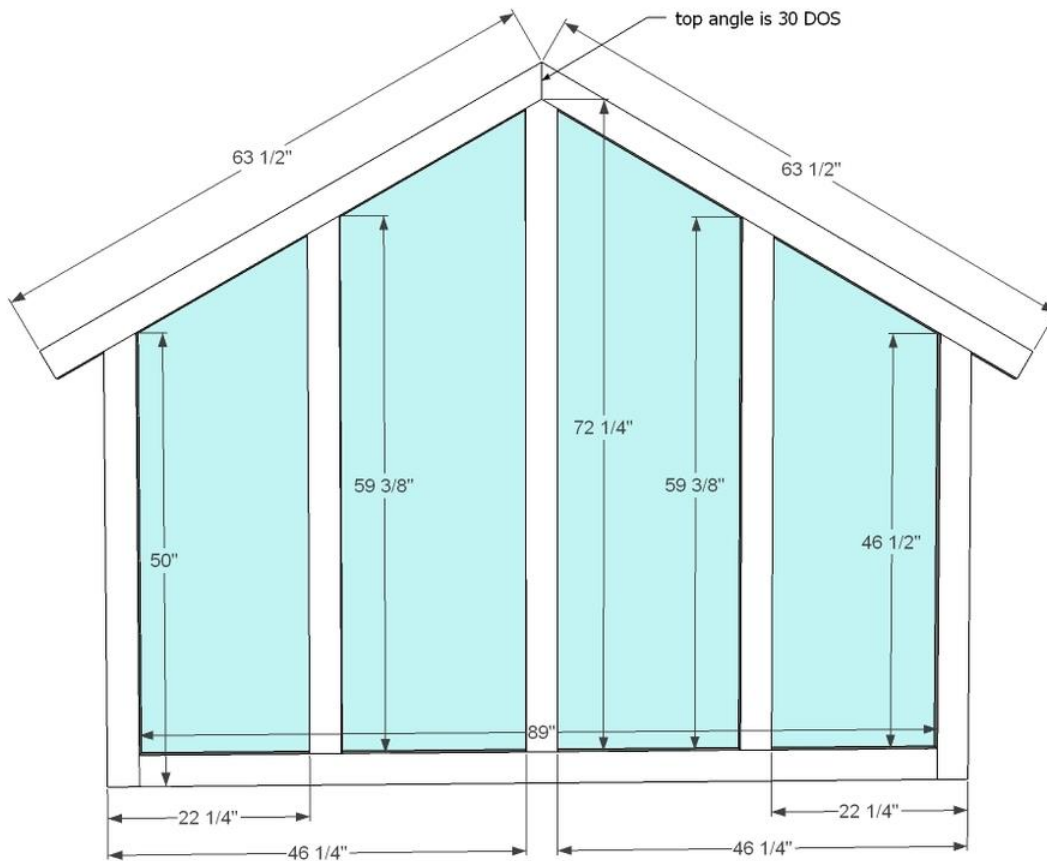

ROOF OVERHANG ON UNDERSIDE OF RAFTERS IS 6"

BACK WALL

- 2 – 2x4 @ $63\frac{1}{2}"$ – one end cut at 30 degrees off square
- 2 – 2x4 @ $50"$ – one end cut at 30 degrees off square
- 2 – 2x4 @ $59\frac{3}{8}"$ – one end cut at 30 degrees off square
- 1 – 2x4 @ $62\frac{1}{4}"$ – top dogeared to point at 30 degrees off square
- 1 – 2x4 @ $89" 2 - \frac{3}{8}"$ exterior plywood 48" cut to fit - save scraps for the front wall.

We built the back wall again on the ground, using the Kreg Jig again. The blue is $\frac{3}{8}"$ exterior plywood nailed on to back. Again, 2x4 boards are joined together flat, so wall is $1\frac{1}{2}"$ thick before plywood is attached.

STEP 3

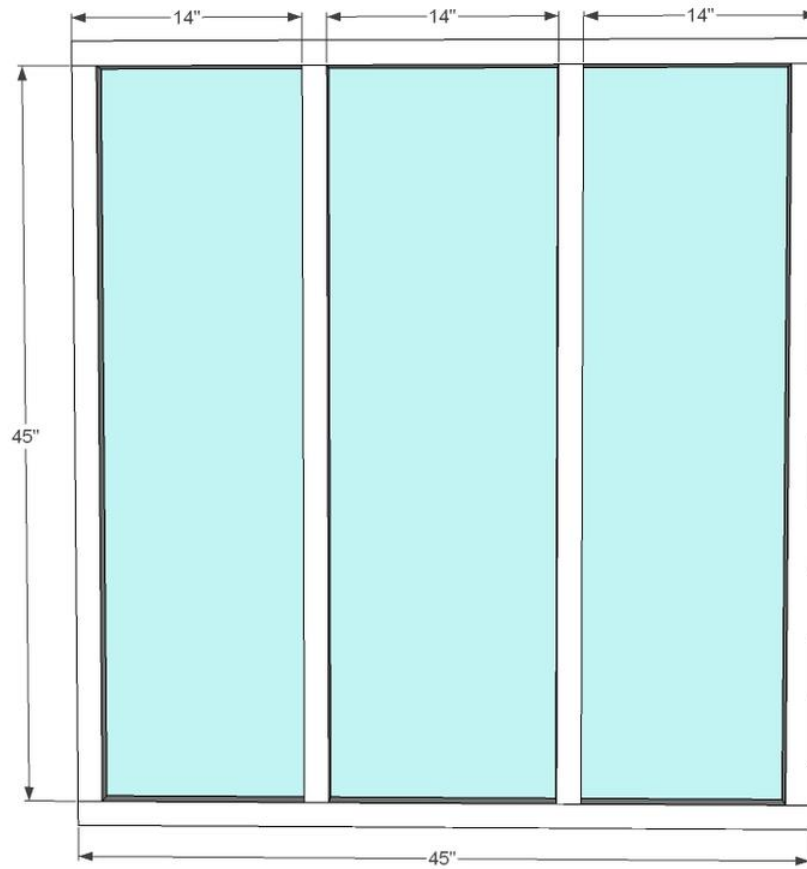

SIDE WALLS – BUILD 2

- 12 – 2x2 @ 45”
- 2 – 1/2" plywood @ 45” x 48”

Build two of the side walls - we used the Kreg Jig here too.

STEP 4

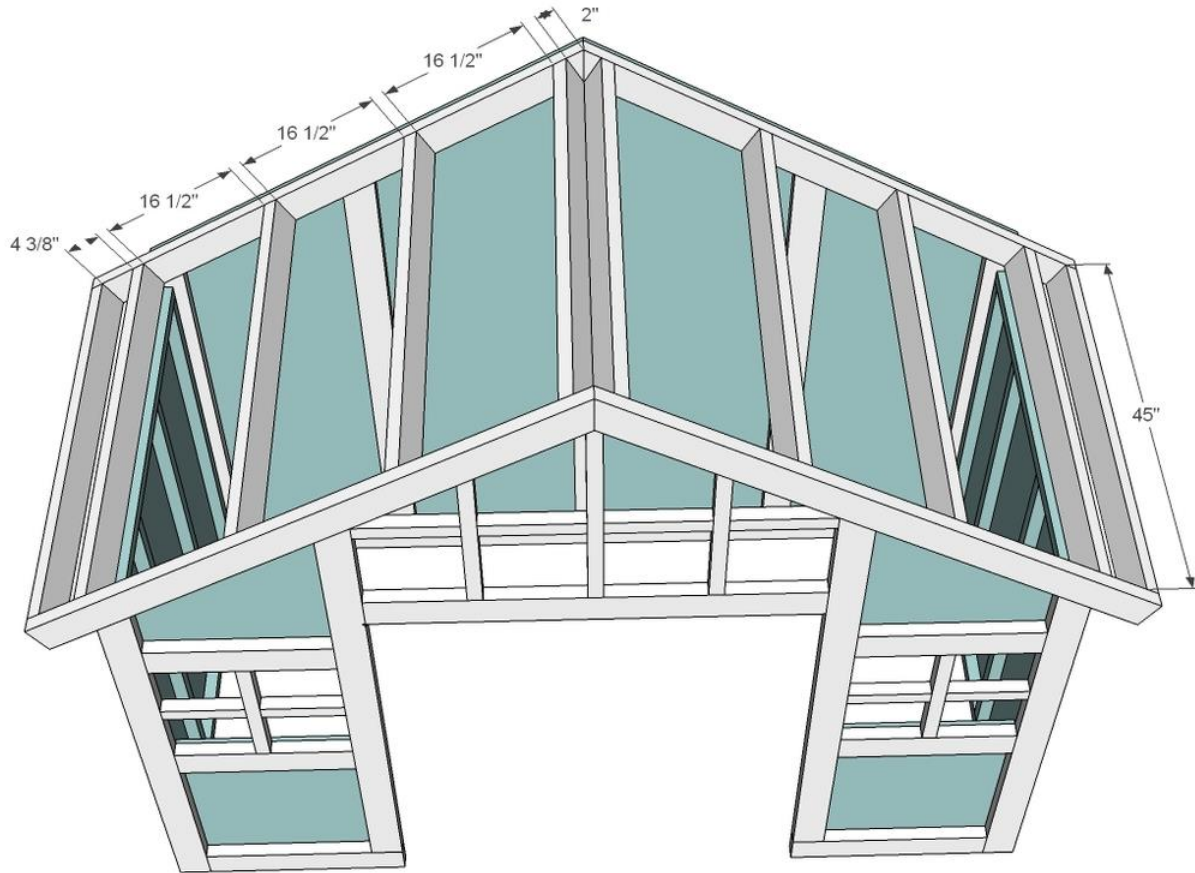

Once all the walls were built, we attached the front and back walls to the side walls to create the walls of the playhouse. Then we added rafters to make the roof.

RAFTERS

- 10 – 2x4 @ 45"

STEP 5



Attach roof plywood to top.

STEP 6



DOORS - BUILD TO YOUR OPENINGS. We recommend leaving generous gaps around the doors to prevent finger pinching.

- 4 – 1x3 @ 48”
- 6 – 1x3 @ 17”
- 2- 1/2” plywood @ 22 1/4” x 48”

We built the doors out of 1x3s and added the 3/8" plywood to the back. If your roof plywood is 3/4" thick, you could just use the slabs as doors. Also, later on we ended up trimming 2" off the bottoms of the doors just so they open easy and no toes get scraped underneath the door.

Finishing/Preparation Instructions

Fill all holes with wood filler and let dry. Apply additional coats of wood filler as needed. When wood filler is completely dry, sand the project in the direction of the wood grain with 120 grit sandpaper. Vacuum sanded project to remove sanding residue. Remove all sanding residue on work surfaces as well. Wipe project clean with damp cloth.

It is always recommended to apply a test coat on a hidden area or scrap piece to ensure color evenness and adhesion. Use primer or wood conditioner as needed.